

Microlinea™ Wall Series 2 - LED

Catalog Number	Type
Project Name	

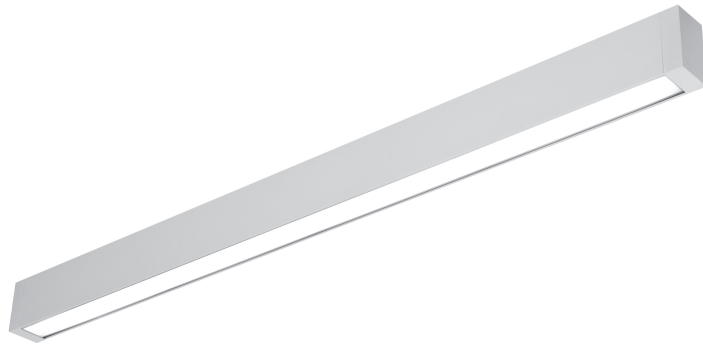

MLP2-D-LED

2 1/4" X 3 1/2" Direct

ADA Compliant



S P E C I F I C A T I O N S

Housing

One-piece .070" thick extruded aluminum. Die-cast aluminum end caps are secured with no visible fasteners. Standard lengths are nominal 2', 3', 4', 6', 8' and 12'. Provisions may be made for continuous rows of any length.

Finish

Standard and premium finishes are baked powder coat electrostatically applied (2.0 mil minimum thickness) to assure aesthetics and durability.

Optical Controls

(LOH) Clear co-extruded 100% D.R. acrylic lens with high transmittance diffusing insert.

Reflector/Heat Sink

.060 thick die-formed aluminum finished with a high reflectance white enamel.

Circuitry

All fixtures are factory pre-wired for a single circuit. Provision for multiple switching/circuiting is optional.

Driver

Osram-Sylvania "Optotronic" power supply is UL/CUL recognized, 0-10V dimming available, 120-277 universal voltage.

Light Engine

Osram-Sylvania LED modules available for 3000K, 3500K and 4000K CCT:

HO-High Output

*2889 Total Delivered Lms. at 40 System Watts (Values per 4' using 4000K LED modules)

MO-Medium Output

*1915 Total Delivered Lms. at 24 System Watts (Values per 4' using 4000K LED modules)

*Due to continued advancement in LED technology, lumen performance is subject to change. Please visit our website for the most up-to-date information.

Wiring

All fixtures intended for continuous rows are provided with factory installed quick-connect wiring.

Integral Controls

Contact factory for daylight and/or occupancy sensor controls.

Certification

All fixtures are ETL listed for use in 'Dry Applications'. 'Damp Location' is optional.

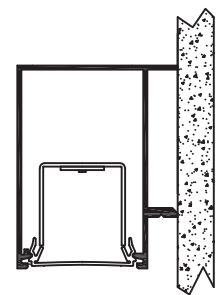

MLP2-D-HO

MLP2-D-MO

Nominal Lengths:
2', 3', 4', 6', 8' and 12'
For continuous rows of 12' or longer, specify nominal row length in 1' increments.

Series
MLP2-D

Mounting
W = Wall

Voltage
120
277

See Microlinea Row Guide section.

MLP2-D-HO-K40-4'-W-LOH-F01M-120-[]

<p>Lumen Output</p> <p>HO - High Output *2889 Total Lumens - 71 Lm/W</p> <p>MO - Medium Output *1915 Total Lumens - 77 Lm/W</p> <p>*Lumen ratings per 4' section (4000K)</p>	<p>CCT</p> <p>K30 3000 Kelvin</p> <p>K35 3500 Kelvin</p> <p>K40 4000 Kelvin</p>	<p>Optical Control</p> <p>LOH LED Optimized High Transmittance Lens</p>	<p>Standard Finishes</p> <p>F01M Matte White</p> <p>Premium Finishes</p> <p>F02 Ivory F03 Stonewash F04 Camel F05 Gray Day F06 Pebble Beach F07 Steel F08 Gray Seal F09 Mocha F10 Bronzed F11G Gloss Black F11M Matte Black</p> <p>F12 Ultrasonic Clear F13 Merlot F14 Red Skies F15 Lemon F16 Forest Hunter F17 Olive F18 Khaki F19 Heather Green F20 Blue Print F21 Reflex Blue F22 Navy FCC Custom Color</p>	<p>Options</p> <p>NLCKT Night Light Circuit (Common Neutral)</p> <p>EMCKT Emergency Circuit (Separate Hot & Neutral)</p> <p>EBPL Emergency Battery Pack (Consult Factory for Specific Application)</p>	<p>Dim Dimming</p> <p>FS Fused Drivers</p> <p>GTD Generator Transfer Device</p> <p>DL Damp Location</p>
---	---	---	---	--	---



Wall

MLP2-D-HO-K40-LOH



Direct - High Output

LED Optimized High Transmittance Lens

Catalog Number: MLP2-D-HO-K40-4'-X-LOH-120

Report Number: ITL#80669.ies

Luminaire Description: Extruded Aluminum Housing with White Aluminum Reflector and LED Optimized Acrylic Lens with Insert

LED Module: Multiple White Low-Power Light Emitting Diodes (LEDs) in a precise lay-out.

Total Luminaire Efficacy = 71.2 Lm/W

0% Up 100% Down

Color Rendering Index (CRI) = 82

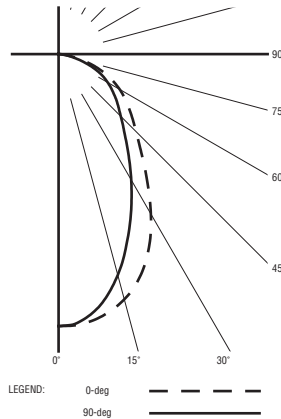

CANDELA DISTRIBUTION

ZONAL LUMEN SUMMARY

Zone	Lumens	%Fixture
0- 30	1065	36.9
0- 40	1569	54.3
0- 60	2413	83.5
0- 90	2889	100.0
90- 180	0	0.0
0- 180	2889	100.0

	0.0	22.5	45.0	67.5	90.0
0	1610	1610	1610	1610	1610
5	1603	1590	1593	1590	1583
15	1503	1467	1425	1373	1354
25	1265	1204	1118	1048	1017
35	914	862	792	741	720
45	649	619	574	535	521
55	490	476	441	407	394
65	339	330	305	280	272
75	160	154	138	123	119
85	22	21	19	18	17
90	0	0	0	0	0

PRECISION ARCHITECTURAL LIGHTING

LED lighting facts®
A Program of the U.S. DOE

Light Output (Lumens) **2889**

Watts **40.6**

Lumens per Watt (Efficacy) **71**

Color Accuracy **82**

Color Rendering Index (CRI)

Light Color **3968 (Bright White)**

Correlated Color Temperature (CCT)

2700K 3000K 4500K 6500K

Warranty** **Yes**

All results, except LED Lumen Maintenance, are according to IESNA LM-79-2008: Approved Method for the Electrical and Photometric Testing of Solid-State Lighting. The U.S. Department of Energy (DOE) verifies product test data and results.

** See www.lightingfacts.com/products for details.

Registration Number: 1NRP-1ALOU8 (4/21/2014)
Model Number: MLP2-HO-40K-4-LOH-120
Type: Luminaire - Linear

MLP2-D-MO-K40-LOH



Direct - Medium Output

LED Optimized High Transmittance Lens

Catalog Number: MLP2-D-MO-K40-4'-X-LOH-120

Report Number: ITL#80670.ies

Luminaire Description: Extruded Aluminum Housing with White Aluminum Reflector and LED Optimized Acrylic Lens with Insert

LED Module: Multiple White Low-Power Light Emitting Diodes (LEDs) in a precise lay-out.

Total Luminaire Efficacy = 77.5 Lm/W

0% Up 100% Down

Color Rendering Index (CRI) = 82

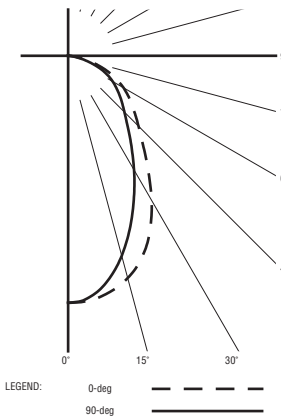

CANDELA DISTRIBUTION

ZONAL LUMEN SUMMARY

Zone	Lumens	%Fixture
0- 30	706	36.9
0- 40	1040	54.3
0- 60	1600	83.6
0- 90	1915	100.0
90- 180	0	0.0
0- 180	1915	100.0

	0.0	22.5	45.0	67.5	90.0
0	1070	1070	1070	1070	1070
5	1064	1058	1056	1055	1050
15	997	975	944	911	897
25	838	799	741	693	675
35	604	571	525	490	478
45	431	411	381	355	345
55	325	314	293	270	261
65	224	219	202	186	181
75	105	102	92	82	79
85	14	14	13	12	11
90	0	0	0	0	0

PRECISION ARCHITECTURAL LIGHTING

LED lighting facts®
A Program of the U.S. DOE

Light Output (Lumens) **1915**

Watts **24.7**

Lumens per Watt (Efficacy) **77**

Color Accuracy **82**

Color Rendering Index (CRI)

Light Color **3949 (Bright White)**

Correlated Color Temperature (CCT)

2700K 3000K 4500K 6500K

Warranty** **Yes**

All results, except LED Lumen Maintenance, are according to IESNA LM-79-2008: Approved Method for the Electrical and Photometric Testing of Solid-State Lighting. The U.S. Department of Energy (DOE) verifies product test data and results.

** See www.lightingfacts.com/products for details.

Registration Number: 1NRP-76AOP6 (4/21/2014)
Model Number: MLP2-MO-40K-4-LOH-120
Type: Luminaire - Linear

For more information, visit our website at www.pal-lighting.com



Precision Architectural Lighting 4830 Timber Creek Drive Houston, Texas 77017
Tel 713.946.4343 Fax 713.946.4441 www.pal-lighting.com



Made in America