

Luminata II Series

Connector Specifications

S P E C I F I C A T I O N S

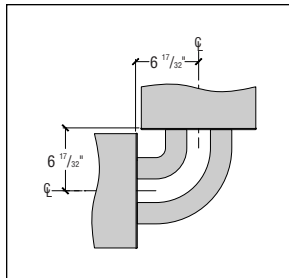

90° Elbow

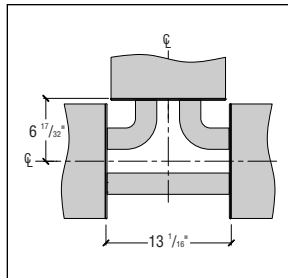

3-Way "T"

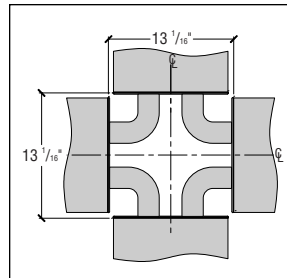

4-Way "X"

Luminata II Series 12" x 3"

Construction .156" thick cast aluminum.

Suspension Contact Factory for suspension point information.

Finish Standard and premium finishes are baked powder coat electrostatically applied (2.0 mil. minimum thickness) to assure aesthetics and durability.

H O W T O O R D E R

Standard Connectors are 2-way 90°, 3-way "T", and 4-way "X".

Catalog Logic

All connectors should be specified and ordered as follows:

Series	Mounting*
	CN = Cable (Non-Tbar) Fully Adjustable (36" Standard)

*Tbar mounting is not applicable when utilizing Connectors to form patterns.

L M S I / D - L 9 0 - C N - F 0 1 M

Connector Type

L90
90° Connector
T
3-Way Connector
X
4-Way Connector

Standard Finish

F01M Matte White
F01G Gloss White
Premium Finishes
F02 Ivory
F03 Stonewash
F04 Camel
F05 Gray Day
F06 Pebble Beach
F07 Steel
F08 Gray Seal
F09 Mocha
F10 Bronzed
F11 Black
F12 Ultrasonic Clear
F13 Merlot
F14 Red Skies
F15 Lemon
F16 Forest Hunter
F17 Olive
F18 Khaki
F19 Heather Green
F20 Blue Print
F21 Reflex Blue
F22 Navy
FCC Custom Color

To view Wood Grain, Marble and Granite Finishes on our Website see "Products"--"Specialty Finishes".



Luminata II Series

Standard Fixture Lengths and Mounting Centers

Cable Mount – Indirect/Direct Configurations

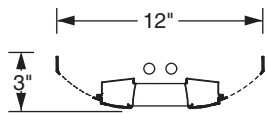

LMSI/D02-T5H0

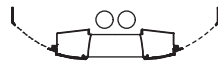

LMSI/D02-T8

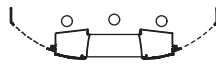
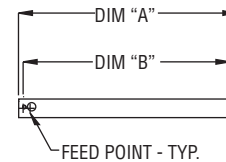
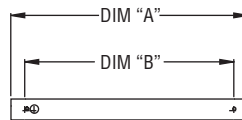

LMSI/D03-T5H0

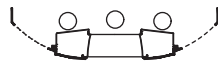

LMSI/D03-T8

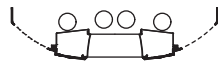

LMSI/D04-T8

EXTENDED END OPTION	
FIXTURE LENGTH DIM. "A"	MOUNTING CENTERS DIM. "B"
60 1/2"	48"
108 1/2"	96"
156 1/2"	144"

SCULPTED END OPTION	
FIXTURE LENGTH DIM. "A"	MOUNTING CENTERS DIM. "B"
48 1/2"	48"
96 1/2"	96"
144 1/2"	144"

Wall Mount – Indirect/Direct Configurations

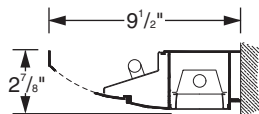

LMPI/D02

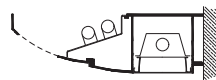
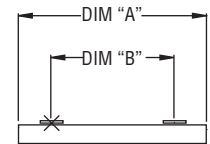
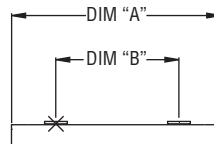
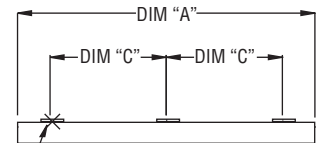
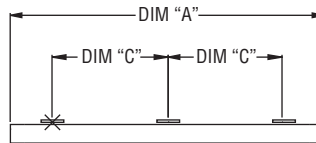
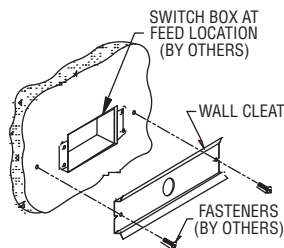

LMPI/D03

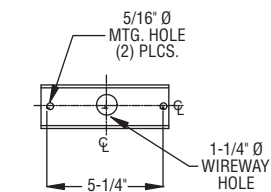

WALL CLEAT
Mounting Hole Arrangement

EXTENDED END OPTION		
FIXTURE LENGTH DIM. "A"	MOUNTING CENTERS DIM. "B" DIM. "C"	
60 1/2"	36"	—
108 1/2"	84"	—
156 1/2"	—	66"

SCULPTED END OPTION		
FIXTURE LENGTH DIM. "A"	MOUNTING CENTERS DIM. "B" DIM. "C"	
48 1/2"	36"	—
96 1/2"	84"	—
144 1/2"	—	66"

PAL RESERVES THE RIGHT TO CHANGE PRODUCT DESIGN AND SPECIFICATIONS. CONTACT FACTORY FOR MOST RECENT PRODUCT INFORMATION.

