

Catalog Number	Type
Project Name	

AR612 • AR613 • AR621

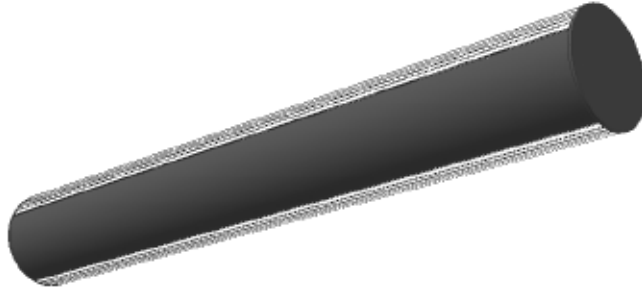

6³/₄" Round
110° Indirect Aperture
60° Direct Aperture
(T8 Lamps)

S P E C I F I C A T I O N S

Housing

Constructed of two-piece .125" thick extruded aluminum. Standard lengths are available up to 12' long in one section. Provisions may be made for continuous rows of any length. Cast aluminum end plates are secured with no visible fasteners.

Optical Control Options (Indirect)

■ Clear extruded DR[®] acrylic linear prismatic lens optically designed to provide maximum efficiency and optimum visual comfort. ■ One piece aluminum radial baffle finished white.

Optical Control Options (Direct)

■ Clear extruded DR[®] acrylic linear prismatic lens optically designed to provide maximum efficiency and optimum visual comfort. ■ Clear extruded DR[®] acrylic wide distribution lens. ■ One piece aluminum radial baffle finished white.

Ballast

Standard ballasts for T8 lamps are UL/CUL Listed, Class P, HPF, Electronic, Universal 120/277volt, Instant Start with <10% THD.

Reflectors

Die-formed from .032" aluminum and finished with a high reflectance baked white enamel.

Finish

Standard and premium finishes are baked powder coat electrostatically applied (2.0 mil minimum thickness) to assure aesthetics and durability.

Circuitry

All fixtures are factory pre-wired for a single circuit. Provision for multiple switching/circuiting is optional.

Certification

All fixtures are UL/CUL listed for use in "Dry Applications". "Damp Location" is optional.

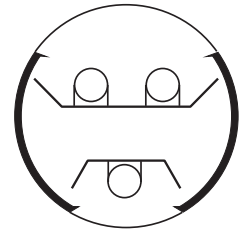

AR612

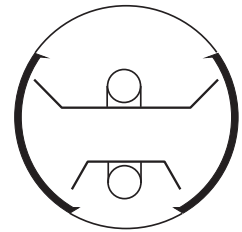

AR613

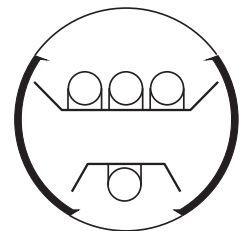

AR621

Standard Lengths:
4', 8', 12'

Mounting

CN = Cable (Non-Tbar) Fully Adjustable (36" Standard)
P = Rigid Stem (Up to 48" Standard)
K = Swivel Stem (Up to 48" Standard)
W = Wall
T = Telescoping End

Series
AR612
AR613
AR621

AR612-12-CN-BW/LP-F01G-V-T8-[]

Indirect Optical Control

LP
Linear Prismatic Lens

BW
White Radial Baffle

OP
Open

Direct Optical Control

LP
Linear Prismatic Lens

WD
Wide Distribution Lens

BW
White Radial Baffle

Standard Finish

F01M Matte White
F01G Gloss White
Premium Finishes
F02 Ivory
F03 Stonewash
F04 Camel
F05 Gray Day
F06 Pebble Beach
F07 Steel
F08 Gray Seal
F09 Mocha
F10 Bronzed
F11 Black
F12 Ultrasonic Clear

F13 Merlot
F14 Red Skies
F15 Lemon
F16 Forest Hunter
F17 Olive
F18 Khaki
F19 Heather Green
F20 Blue Print
F21 Reflex Blue
F22 Navy
FCC Custom Color

Voltage

120
277
347

Lamp Type

T8
T5*

Options

EM
Emergency Battery Pack
2Ckt
Two Circuit Wiring
SS
Separate Switching
(Common Neutral Utilized)
Dim
Dimming
FS
Fused Ballasts

*For T5/T5HO lamping options contact factory

To view Wood Grain, Marble and Granite Finishes on our Website see "Products"--"Specialty Finishes".



Precision Architectural Lighting

Tel (713) 946-4343 Fax (713) 946-4441 www.pal-lighting.com

4830 Timber Creek Drive Houston, Texas 77017

AR612

6³/₄" Round Indirect/Direct

Linear Prismatic Lens - Indirect

Linear Prismatic Lens - Direct

Catalog Number: AR612-4-X-LP/LP-F01-120-T12

Report Number: LTL #00526.ies

Luminaire Description: Extruded Aluminum Housing, White Enamel Reflectors

Lamps: Three F40T12/CW rated at 3150 lumens each

Spacing Criteria: 0° 90°
1.2 1.2

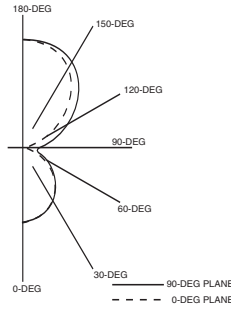

CANDELA DISTRIBUTION

	0.0	22.5	45.0	67.5	90.0	
0	732	732	732	732	732	
5	723	728	728	728	730	69
15	696	700	699	699	699	197
25	639	641	638	641	642	295
35	555	555	555	560	562	348
45	442	442	451	459	460	348
55	307	317	335	347	349	297
65	165	194	228	246	251	218
75	57	96	152	175	180	145
85	7	48	131	159	162	279
90	1	51	142	173	176	
95	11	74	171	206	211	155
105	83	162	267	303	312	247
115	248	312	406	445	453	376
125	461	507	577	614	623	500
135	655	693	747	781	789	567
145	814	841	886	912	920	548
155	937	955	980	1003	1010	451
165	1023	1030	1043	1054	1058	294
175	1064	1067	1068	1071	1073	102
180	1072	1072	1072	1072	1072	

COEFFICIENTS OF UTILIZATION - ZONAL CAVITY METHOD

Effective Floor Cavity Reflectance 0.20

RC	80			70			50			30			10			0		
RW	70	50	30	10	70	50	30	10	50	30	10	50	30	10	50	30	10	0
0	60	60	60	60	55	55	55	55	45	45	45	36	36	36	27	27	27	23
1	54	51	49	47	49	47	45	43	38	37	35	30	29	28	23	22	21	18
2	49	45	41	38	45	41	38	35	33	31	29	26	25	23	20	19	18	15
3	45	40	35	32	41	36	32	29	30	27	25	24	22	20	18	17	15	13
4	41	35	30	27	37	32	28	25	26	23	21	21	19	17	16	15	13	11
5	38	31	26	23	34	28	24	21	23	20	18	19	16	15	14	13	11	9
6	35	28	23	20	31	25	21	18	21	18	16	17	15	13	13	11	10	8
7	32	25	20	17	29	23	19	16	19	16	13	15	13	11	12	10	9	7
8	30	22	18	15	27	21	17	14	17	14	12	14	11	10	11	9	8	6
9	27	20	16	13	25	19	15	12	15	12	10	12	10	8	10	8	7	5
10	25	18	14	11	23	17	13	11	14	11	9	11	9	7	9	7	6	5

QUICK SELECTION TABLE

Number of 4' luminaires required for initial illumination of 50 footcandles

Luminaire suspension length = 18" Working Plane Height = 30" Floor Reflectance = .20

Room HT	8				9				10				12				
Ceiling RF	80		70		80		70		80		70		80		70		
Wall RF	70	50	50	30	70	50	50	30	70	50	50	30	70	50	50	30	
Width	Length																
10.	10.	2	2	2	2	2	2	2	2	2	3	3	2	3	3	4	
10.	15.	2	3	3	3	2	3	3	3	3	3	4	3	4	4	5	
15.	20.	4	4	5	5	4	4	5	5	4	5	5	6	5	6	7	
15.	30.	5	6	6	7	6	6	7	7	6	7	8	6	7	8	9	
20.	20.	5	5	6	6	5	6	6	7	5	6	6	7	6	7	8	
20.	30.	7	7	8	8	7	8	8	9	7	8	9	10	8	9	10	
20.	40.	9	9	10	11	9	10	11	12	9	10	11	12	10	11	12	
20.	60.	13	13	15	15	13	14	15	16	13	15	16	17	14	16	17	
30.	30.	10	10	11	12	10	11	12	12	10	11	12	13	11	12	13	
30.	40.	12	13	14	15	13	14	15	16	13	14	15	17	14	15	17	
30.	50.	15	16	18	18	16	17	18	19	16	17	19	20	17	18	20	
30.	60.	18	19	21	22	18	20	22	23	19	20	22	24	20	22	24	
60.	60.	34	36	39	40	35	36	40	42	36	38	41	43	37	39	43	
60.	80.	45	47	51	52	46	48	52	54	47	49	54	56	48	51	56	59
60.	100.	56	58	63	65	57	59	65	66	58	60	66	68	59	63	69	72
100.	100.	92	94	103	105	93	95	104	107	94	97	106	109	96	100	110	114

AR621

6³/₄" Round Indirect/Direct (T8 Lamps)

Linear Prismatic Lens - Indirect

Linear Prismatic Lens - Direct

Catalog Number: AR621-4-X-LP/LP-F01-120-T8

Report Number: LTL #01113.ies

Luminaire Description: Extruded Aluminum Housing, White Enamel Reflectors

Lamps: Four F032T8/RS rated at 2900 lumens each

Spacing Criteria: 0° 90°
1.2 1.3

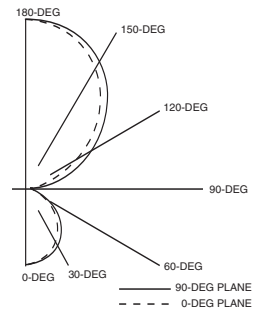

CANDELA DISTRIBUTION

	0.0	22.5	45.0	67.5	90.0	
0	699	699	699	699	699	
5	695	696	697	699	699	66
15	668	671	677	685	688	191
25	613	620	634	643	646	291
35	532	543	557	564	566	346
45	426	438	450	454	455	344
55	297	311	326	328	324	286
65	157	186	209	210	208	196
75	51	85	113	114	110	105
85	6	24	50	52	51	44
90	1	32	75	76	74	
95	17	95	181	180	172	153
105	122	228	339	349	347	306
115	367	447	544	563	564	501
125	680	724	786	811	807	685
135	958	998	1037	1052	1054	789
145	1183	1217	1250	1270	1274	777
155	1357	1381	1400	1419	1421	645
165	1475	1482	1499	1511	1514	423
175	1534	1537	1540	1544	1543	147
180	1545	1545	1545	1545	1545	

COEFFICIENTS OF UTILIZATION - ZONAL CAVITY METHOD

Effective Floor Cavity Reflectance 0.20

RC	80			70			50			30			10			0		
RW	70	50	30	10	70	50	30	10	50	30	10	50	30	10	50	30	10	0
0	56	56	56	56	50	50	50	50	39	39	39	29	29	29	20	20	20	16
1	51	48	46	45	45	44	42	40	34	33	32	26	25	25	18	18	17	14
2	46	42	39	37	41	38	36	33	30	28	27	23	22	21	16	15	15	12
3	42	37	34	31	38	34	31	28	27	25	23	20	19	18	14	14	13	10
4	39	33	29	26	35	30	26	24	24	21	19	18	17	15	13	12	11	9
5	35	29	25	22	32	27	23	20	21	19	17	16	14	13	12	10	10	8
6	33	26	22	19	29	24	20	17	19	16	14	15	13	11	10	9	8	7
7	30	24	19	16	27	21	18	15	17	14	12	13	11	10	9	8	7	6
8	28	21	17	14	25	19	16	13	15	13	11	12	10	9	8	7	6	5
9	26	19	15	13	23	17	14	11	14	11	9	11	9	8	8	6	6	4
10	24	17	14	11	21	16	12	10	13	10	8	10	8	7	7	6	5	4

QUICK SELECTION TABLE

Number of 4' luminaires required for initial illumination of 50 footcandles

Luminaire suspension length = 18" Working Plane Height = 30" Floor Reflectance = .20

Room HT	8				9				10				12					
Ceiling RF	80		70		80		70		80		70		80		70			
Wall RF	70	50	50	30	70	50	50	30	70	50	50	30	70	50	50	30		
Width	Length																	
10.	10.	2	2	2	2	2	2	2	2	2	2	2	2	3	2	3	3	3
10.	15.	2	2	2	3	2	2	3	3	2	3	3	3	3	3	3	4	4
15.	20.	3	4	4	4	4	4	4	4	4	4	5	4	4	5	4	5	6
15.	30.	5	5	6	6	5	5	6	6	5	6	6	7	6	6	7	8	8
20.	20.	4	5	5	5	4	5	5	6	5	5	6	6	5	6	6	7	8
20.	30.	6	6	7	7	6	7	7	8	6	7	7	8	6	7	8	8	9
20.	40.	8	8	9	9	8	8	9	10	8	9	10	11	9	10	11	12	12
20.	60.	11	12	13	13	11	12	13	14	12	13	14	15	12	14	15	17	18
30.	30.	8	9	10	10	9	9	10	11	9	10	11	11	9	10	11	13	13
30.	40.	11	11	13	13	11	12	13	14	11	12	14	14	12	13	15	16	16
30.	50.	13	14	15	16	14	14	16	17	14	15	17	17	15	16	18	19	19
30.	60.	16	17	18	19	16	17	19	20	16	18	19	21	17	19	21	22	22
60.	60.	30	31	34	35	31	32	35	36	31	33							